

LOCATION PLAN



KINETIC INFRA CONSTRUCTION

Real Estate Promoters, Developers & Builders

Site: Kaiser Colony, Jora Talab Road, Bariatu, Ranchi - 834009

Office: Ground Floor, S. Tower, Church Road, Ranchi - 834001 (Jharkhand)
Tel.: 0651-2351235, Email: waseemraza@kineticinfra.in
Web : www.kineticinfra.in

Marketing by



M-Tech Buildcon Pvt. Ltd.

S-12, S. Tower, Church Road
Ranchi-834001 (Jharkhand)

Booking Contact

Waseem Raza 9308069808
Zakir Khan 9470561786
Nooruddin Jangi 9631880203

Presented by



Axix Tower

Block - A

Shakeela Tower

Block - B

Sabiha Tower

Block - C

Sarsar Tower

Block - D

Bariatu, Ranchi



Wish a little
more
dream a little
bigger



ASSS
CITY

This brochure is purely conceptual and not a legal offering. The Promoter reserve the right to add/ delete/ alter any detail/ specification/ elevation mentioned herein.

Note: The images and material contained in the brochure are conceptual illustrations. Only the Actual agreement (to be entered into between the purchaser and the developer), shall be binding on the Parties and the actual layouts, and specifications of the individual plot and any amenities to be provided, stated therein shall be final and conclusive of the agreed terms, offered to the Purchaser by the Developer. The Developer reserves the rights to make alterations, modifications, and changes in the sanctioned plan, layout, specification, plots, elevations, designs, and amenities that will be made available in the project.



BUILDER / PROMOTER

www.kineticinfra.in



BUILDER / PROMOTER

www.kineticinfra.in

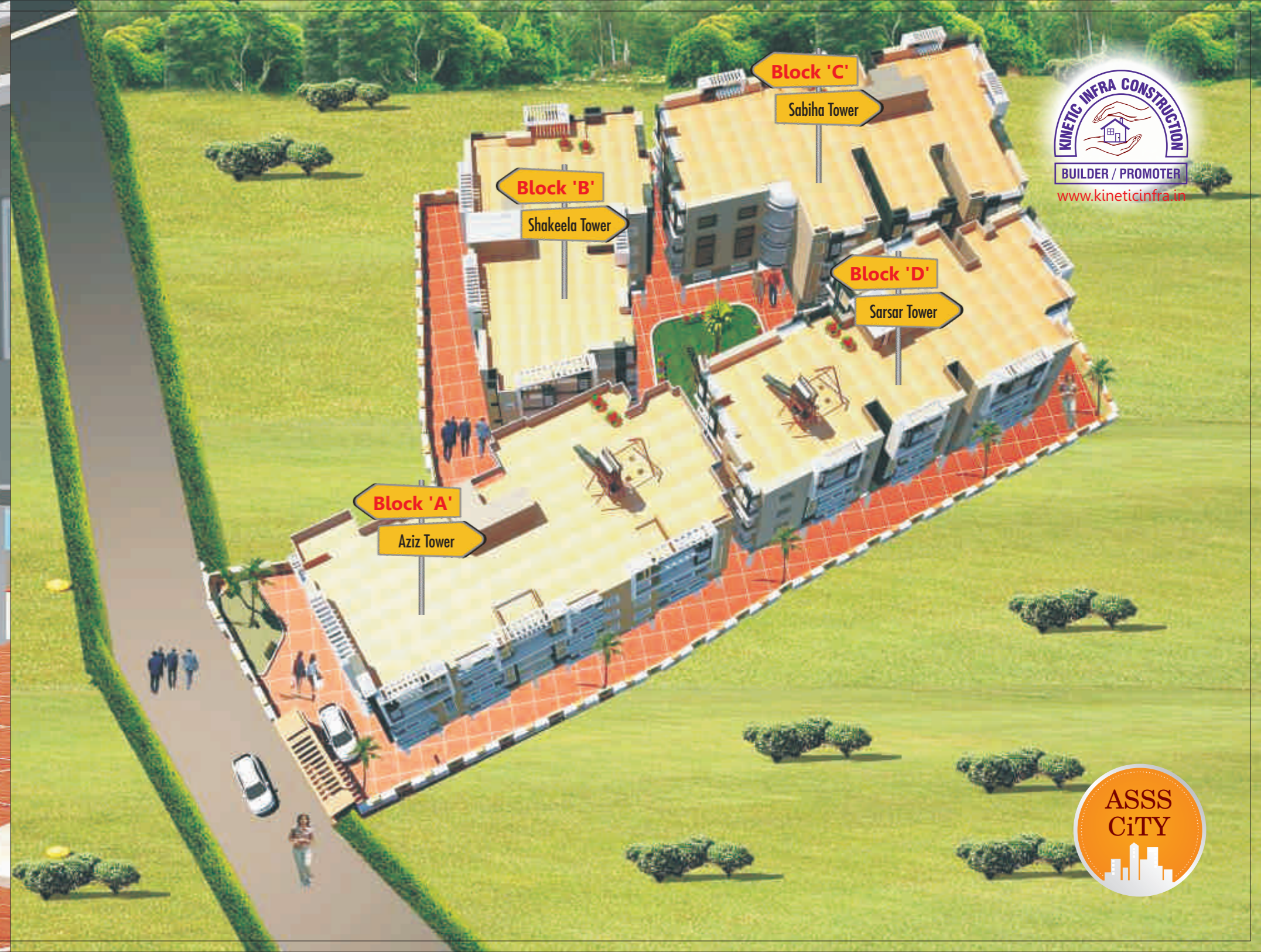

ASSS
CiTY



Typical Floor Plan (Block-A)



FLAT - A	1240 SQ.FT.	3 BHK
FLAT - B	1275 SQ.FT.	3 BHK
FLAT - C	1240 SQ.FT.	3 BHK
FLAT - D	1215 SQ.FT.	3 BHK
FLAT - E	1260 SQ.FT.	3 BHK

Typical Floor Plan (Block-B)

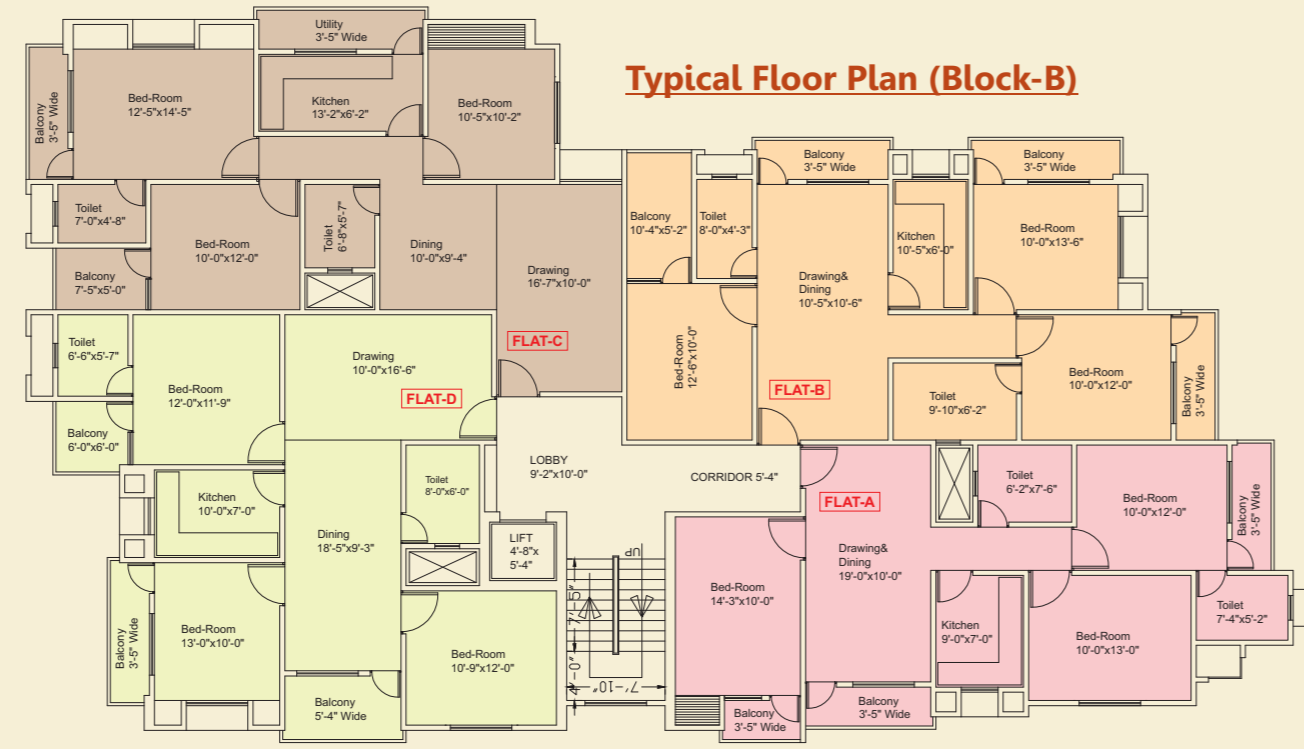

FLAT - A	1200 SQ.FT.	3 BHK
FLAT - B	1305 SQ.FT.	3 BHK
FLAT - C	1360 SQ.FT.	3 BHK
FLAT - D	1395 SQ.FT.	3 BHK



Typical Floor Plan (Block-C)



FLAT - A	1050 SQ.FT.	2 BHK
FLAT - B	945 SQ.FT.	2 BHK
FLAT - C	1310 SQ.FT.	3 BHK
FLAT - D	1490 SQ.FT.	3 BHK
FLAT - E	955 SQ.FT.	2 BHK
FLAT - F	905 SQ.FT.	2 BHK



Typical Floor Plan (Block-D)

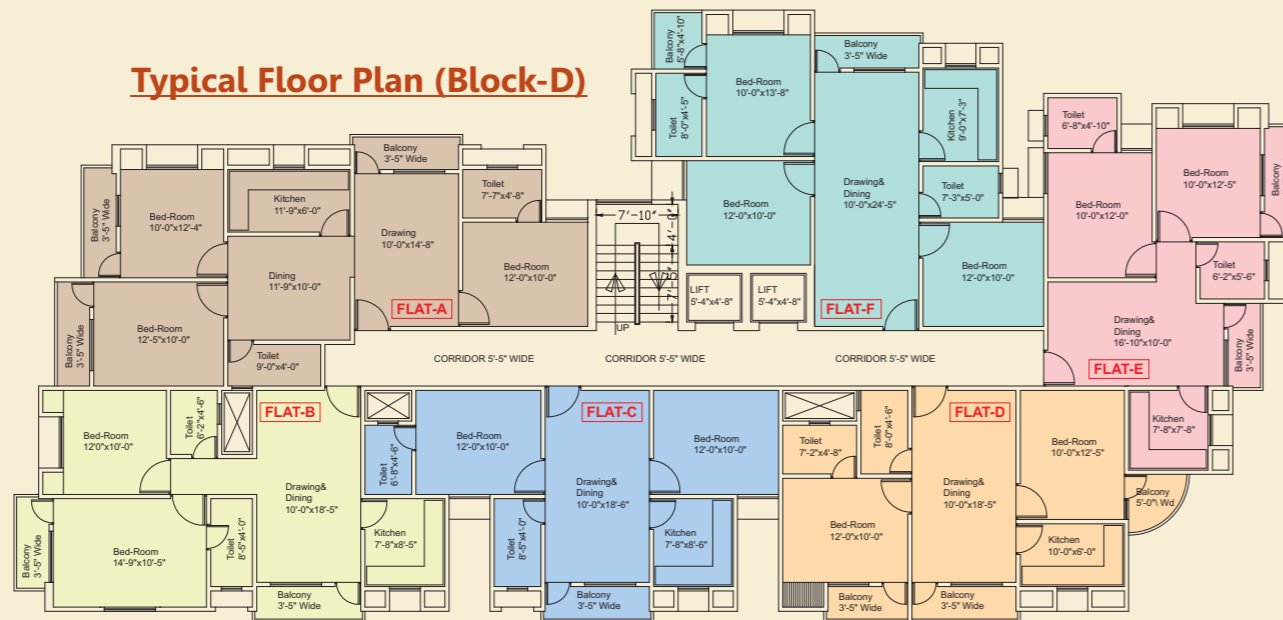

FLAT - A	1225 SQ.FT.	2 BHK
FLAT - B	935 SQ.FT.	2 BHK
FLAT - C	825 SQ.FT.	2 BHK
FLAT - D	905 SQ.FT.	2 BHK
FLAT - E	860 SQ.FT.	2 BHK
FLAT - F	1145 SQ.FT.	3 BHK



Specification

- Foundation** : RCC frame structure will be seismic resistant with anti termite treatment both in foundation and plainth.
- Structure** : Lower Ground Plus Four storied building.
- Wall** : Red bricks in cement mortar as per specification of structure consultant.
- Wall Finish** : Internal wall and ceiling finish will be plaster of paris finish. External wall finish will be of two coat of weather coat over wall care putty.
- Floor** : Kitchen, Bedroom and Balcony with Marble Slab / Vitrified Tiles floors with non skid ceramic tiles, Stairs and Lobby floor with Marble Tiles / Equivalent and Parking floors with crazy flooring of equivalent.
- Door** : All doors frame (Choukhat) with salwood frame and flush door. Door / Water Proof and other and other doors will be flush door with coat of wood primer.
- Windows** : Glass fitted Aluminium sliding windows with fabricated steel grill.
- Toilet** : Every toilets walls with colored & glazed tiles up to 7 feet height, provision for Geyser & Exhaust, One Pan, One Wash Basin, One Cistern (PVC) Shower & Tap Systems, One Pan Indian and other European. All Sanitary wares, accessories, pipes etc. of Premium Brands (Equipment not provided).
- Kitchen** : Green Top Marbles, One Steel Sink, Colored and Glazed Ceramic Tiles upto 24 inches height, Provision for Electrical Points for Fridge, Filter and Kitchen equipments.
- Electrical** : Concealed copper wiring with ISI mark ISO 9001-2008 certified and fixture of standard brands, Master Bedroom with A.C. Point (One Bedroom). All flats & common area will have adequate number of electrical points. Electrical fitting on Anchor / Havells.
- Sewarage** : Sewerage disposal through Septic Tank & Soak Pit having of standard PVC pipes with adequate chambers.

Features

- LG+4 Floors, Lower Floor for Parking Vehcles of the Resident, Guard Room, Generator Room, Common Toilet etc.
- Cable TV and Telephone wiring in Drawing Room and Master Bedroom.
- Round the clock water supply through to deep borewell with overhead tanks.
- Lighting in the entire campus through back-up in the entire campus.
- Silent Diesel Generator set of adequate capacity for back-up power supply for common area lighting, lift, water pump sets to each flat.
- Loan facility will be arranged from bank.
- Lighting Conductor.
- 24 Hours Security.
- CCTV Camera
- All flats as per Vastu.

Payment Schedule

● Initial Booking Amount	-	25%
● At the time of 1st Roof Casting	-	15%
● At the time of 2nd Roof Casting	-	15%
● At the time of 3rd Roof Casting	-	15%
● At the time of 4th Roof Casting	-	15%
● At the time of 5th Roof Casting	-	15%
● At the time of possession	-	5%

Other Charges:-

● Parking	-	1,50,000/-
● Electric + Lift + Generator	-	1,00,000/-
Total	-	2,50,000/-

